

NEK6214Z



**ENGINEERING CODE**  
269JA58



**REFRIGERANT**  
R-134a



**POWER SUPPLY**  
220-240 V 50 Hz



**APPLICATION**  
HBP



**MOTOR TYPE**  
CSIR



**STANDARD**  
CECOMAF



**COOLING CAPACITY**  
1217 W



**EFFICIENCY**  
1.71 W/W



DATA

GENERAL DATA

Model	NEK6214Z
Type	Hermetic Reciprocating
Technology	ON/OFF
Compressor Application	HBP
Expansion Device	Capillary Tube or Expansion Valve
Compressor Cooling	Fan/220
HP	3/4-
Starting Torque	HST
Plant	SLOVAKIA

ELECTRICAL DATA

Start Winding Resistance	10.63 Ω at 25°C
Run Winding Resistance	3.13 Ω at 25°C

## MECHANICAL DATA

Displacement	16.8 cm <sup>3</sup>
Oil Charge	350 ml
Oil Type	ESTER
Oil Viscosity	ISO22
Weight	11.6 Kg

## ELECTRICAL COMPONENTS

Start Capacitor	72-88 µf/330 V
CSR CSIR BOX	No
Starting Device Type	RELAY
Starting Device Description	MTRPH-0012-65*
Overload Protection	T0899/G6

## PERFORMANCE

### TESTED CONDITIONS

Tested Refrigerant	R-134a
Tested Application	HBP
Tested Standard	CECOMAF
Tested Cooling	Fan
Tested Voltage	220 V
Refrigerant Temperature	Dew

### RATED POINTS

Condensing Temperature °C	Evaporating Temperature °C	Cooling Capacity W	Efficiency W/W	Power Consumption W	Current A	Gas Flow Rate kg/h
55	5	1217	1.71	714	-	29.91

Test Condition: Subcooling 0 K, Return Gas 32 °C. Data are an indication of performance based simulation.

### PERFORMANCE CURVE

Condensing Temperature 35°C

Evaporating Temperature °C	Cooling Capacity W	Efficiency W/W	Power Consumption W	Current A	Gas Flow Rate kg/h
-15	651	1.58	413	-	13.00
-10	832	1.82	458	-	16.67
-5	1047	2.06	509	-	21.05
0	1297	2.32	559	-	26.21
5	1584	2.64	601	-	32.21
10	1909	3.04	628	-	39.10

Test Condition: Subcooling 0 K, Return Gas 32 °C. Data are an indication of performance based simulation.

## PERFORMANCE CURVE

Condensing Temperature 45°C

Evaporating Temperature °C	Cooling Capacity W	Efficiency W/W	Power Consumption W	Current A	Gas Flow Rate kg/h
-15	568	1.27	447	-	12.36
-10	729	1.48	492	-	15.92
-5	920	1.67	550	-	20.19
0	1144	1.86	615	-	25.24
5	1402	2.06	681	-	31.14
10	1695	2.29	740	-	37.95

Test Condition: Subcooling 0 K, Return Gas 32 °C. Data are an indication of performance based simulation.

## PERFORMANCE CURVE

Condensing Temperature 55°C

Evaporating Temperature °C	Cooling Capacity W	Efficiency W/W	Power Consumption W	Current A	Gas Flow Rate kg/h
-10	627	1.23	508	-	15.11
-5	794	1.41	564	-	19.23
0	990	1.56	634	-	24.14
5	1217	1.71	714	-	29.91
10	1477	1.86	794	-	36.59

Test Condition: Subcooling 0 K, Return Gas 32 °C. Data are an indication of performance based simulation.

## ENVELOPE



## External

### EXTERNAL CHARACTERISTICS

Base Plate		SMALL	
Tray Holder		YES	
Connector	Internal Diameter	Shape	Material
Suction	8.1 mm	SLANTED 42°	COPPER
Discharge	6.1 mm	STRAIGHT	COPPER
Process	6.1 mm	SLANTED 42°	COPPER

## EXTERNAL DIMENSIONS

### SHELL

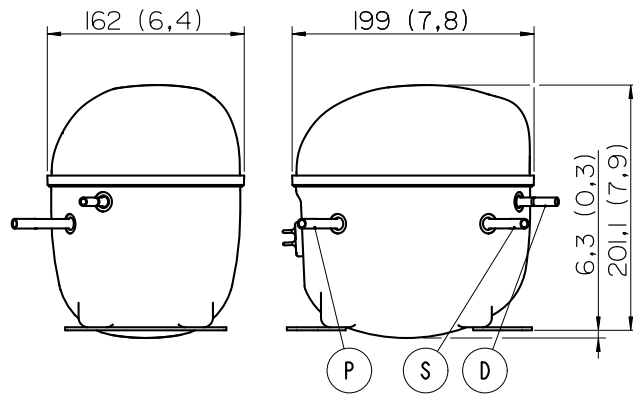

### BASE

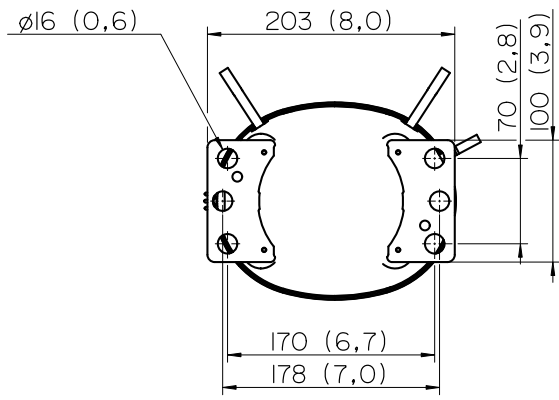

### FENCE

